

## Crane Barge 2 (99'L x 88'W x 10'H) Draft = 3'

### Description

The Crane Barge 2 is a pontoon-type barge made up of twenty-four separate pontoons, measuring 33' long by 11' wide by 10' deep. There are three rows of eight pontoons, with a total barge dimension 88' wide by 99' long by 10' deep. The forward pontoons have raked ends on the bow. All of the other pontoons are rectangular in shape. The pontoons are bolted together with 8 bolts on the bottom and 4 bolts on the top. Each pontoon has six 8-bolt sets per side, six 4-bolt sets per side and two 8-bolt sets and two 4-bolt sets on each end. The bolts are 1" and extend either into the adjacent barge or through the side, either to fill an empty slot or to secure a tire pad eye.

### Equipment

Name	Description	Qty
Conmaco Amcon Model 385	Double drum waterfall winch. Powered by a Caterpillar C7 diesel. Serial numbers 0711083 and 0711085.	2
Small Operator House	Contains controls for all deck machinery. Equipped with roof mounted A/C. Watertight door. 3 windows.	1
Timberland Equipment LTD Model GP1000 1-1H	Hydraulic spud winch. Serial numbers: 07-8317-1, 07-8317-3, and 07-8317-8.	3
Timberland Equipment LTD Hydraulic Power Pack	Model not specified. Powered by Caterpillar diesel engine.	1
1,000gal Fuel Tank	In secondary containment tray.	1



CB-2



CB-2

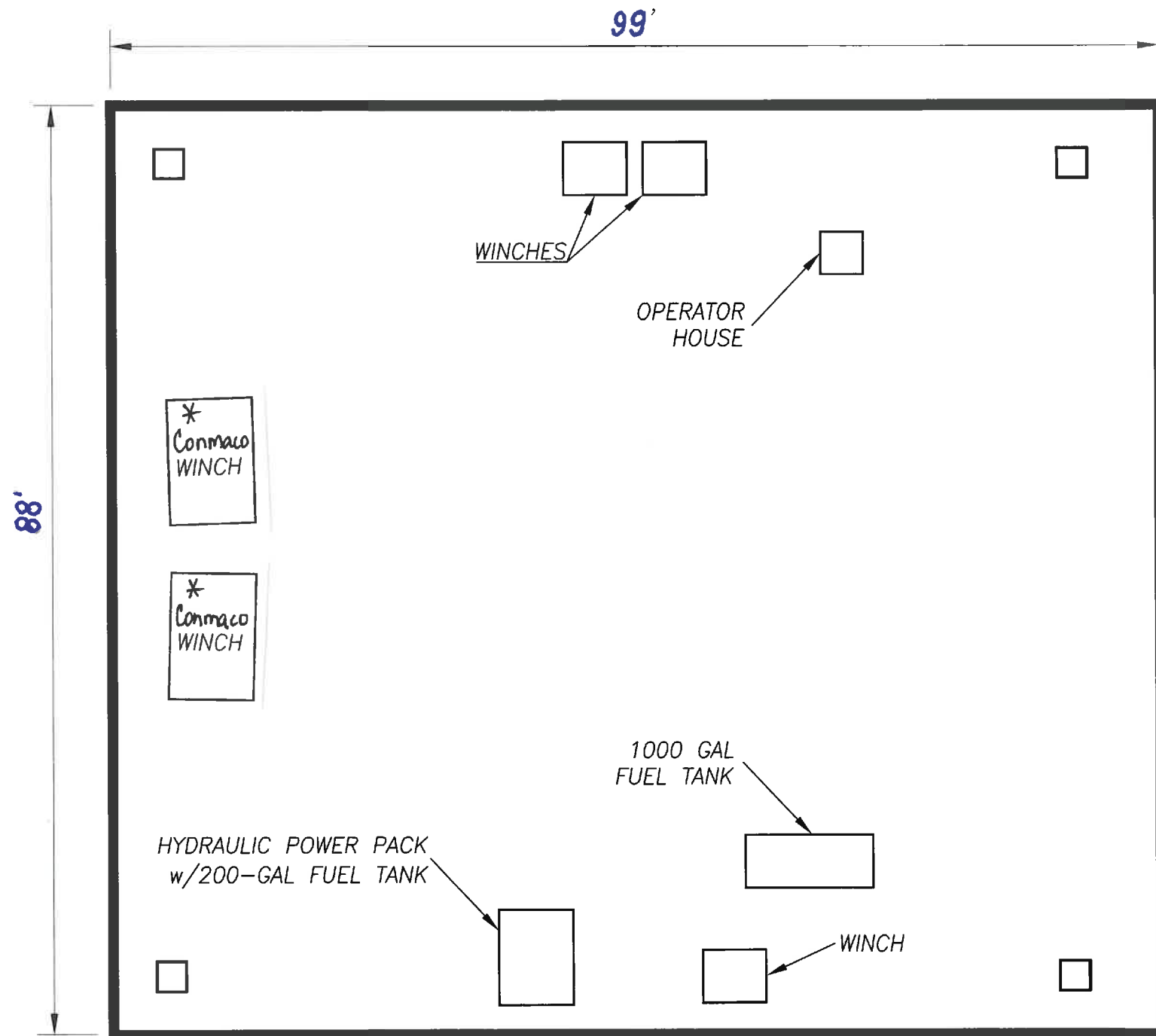

\* Currently Installed on DC Barge. Will be reinstalled on CB-2. Location to be determined. (Conmaco Winch)

CRANE BARGE-2